

STATE OF NEVADA

BRIAN SANDOVAL  
*Governor*

RICHARD WHITLEY, MS  
*Director*



CODY L. PHINNEY, MPH  
*Administrator*

TRACEY D. GREEN, M.D.  
*Chief Medical Officer*

**Department of Health and Human Services**  
**DIVISION OF PUBLIC AND BEHAVIORAL HEALTH**

Radiation Control Program  
675 Fairview Drive, Suite 218  
Carson City, Nevada 89701

Telephone: (775) 687-7550 · Fax: (775) 687-7552

October 22, 2015

MEMORANDUM

To: Beatty File

From: John Follette, Radiation Control Specialist

Subject: First Beatty Inspection Fiscal Year 2016

---

The first inspection for fiscal year 2016 of the Beatty Low-Level Waste landfill (closed) was conducted on October 21, 2015. The radiological survey was performed by walking a BNC Model RD-120 GN radiation detection system in a grid pattern across the surface of the site (i.e., the cap) to detect radiological anomalies. No anomalies were detected. Dose rate readings on the cap remain about twice background as read on surrounding areas. This is consistent with previous surveys.

The inspection was performed following an incident that involved a fire at the site on Sunday, October 18, 2015. In addition to the damage associated with the fire, which occurred near trench number 14, additional erosion was noted at the site as listed below:

- Trench 20, there is a large square shaped whole approximately 9ft. X 9ft., about 4ft. deep. There are visible tunnels that run deeper than 4ft. Repairing this whole should be a high priority with regards to repairing the cap.
- Trench 20 has additional erosion sites of crack and pocket type holes.
- Trench 21 has three holes between 6in. and 24in. across and anywhere from 6in. to 12in. deep, there are also channels/cracks that range from 5ft. to 15ft. long and have depths from 3in. to 12in., and one has a deep tunnel running further underground.
- Trench 22 has cracks and there is erosion and runoff debris along the edge of the site down to the fence boundary.
- Trench 14 has a large erosion area that consists of a channel that is roughly J shaped and contains holes with deep tunnels. The size of the erosion is about 24ft. X 28ft.

It should also be noted that the cap has a relatively flat surface (not domed or very sloped). As a result, there are areas within the cap where water has pooled. Water appears to be moving under

the surface of the cap through tunnels that are not visible from the surface until a subsidence occurs.

It was also noted that during the last repair of the cap, some of the trench markers may have been moved.

See attached maps.

USGS continues to maintain soil monitoring tubes that are used for the spring environmental sampling activities.

Contact: John Follette 702-486-3017, [jfollette@health.nv.gov](mailto:jfollette@health.nv.gov)

Large pool of water  
outside fence  
boundary

Lot of run off debris along this side

Beatty Inspection 10-21-15

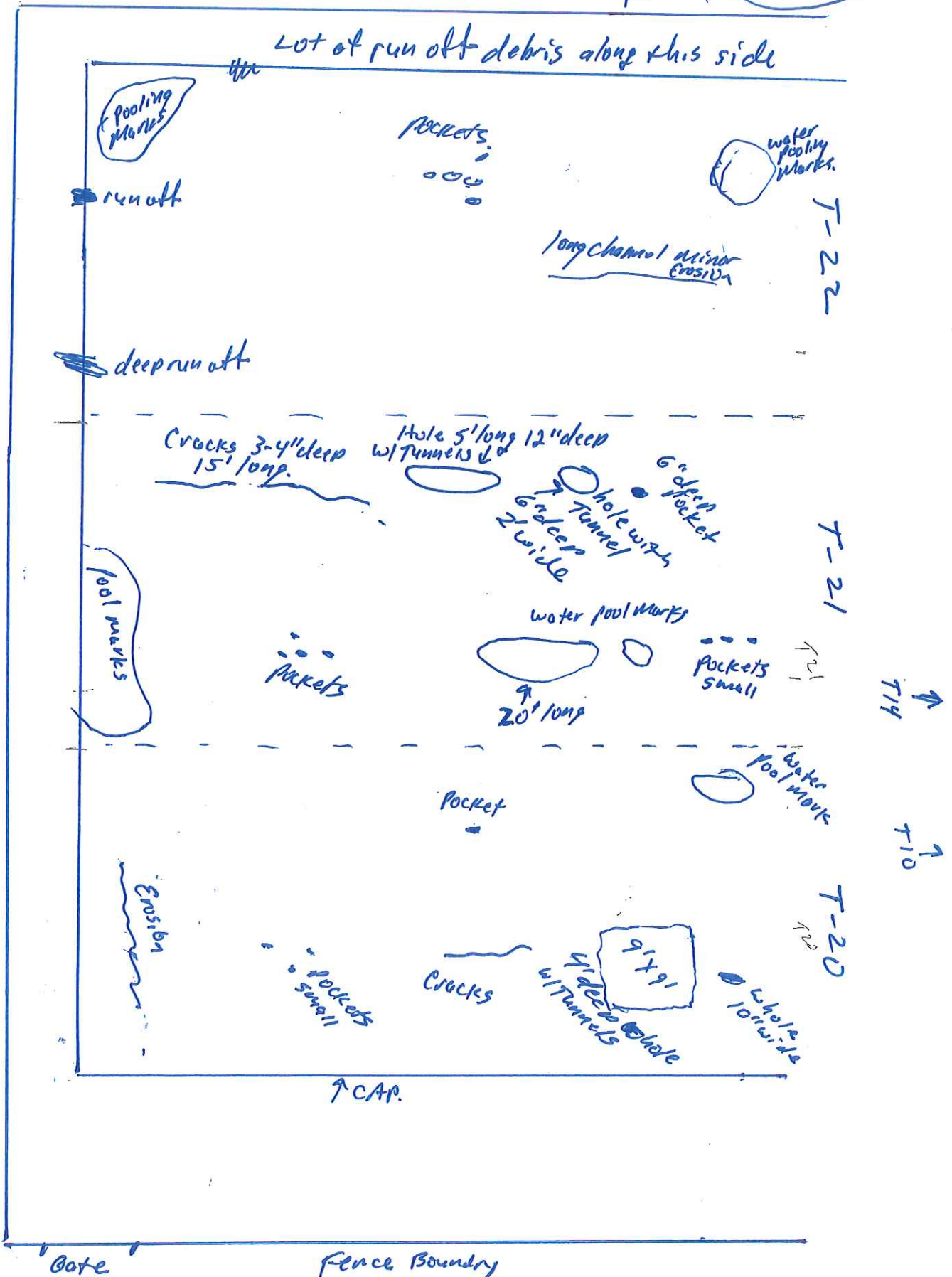

LEGEND  
ISLANDS OF COMPLETED TRENCH

KEY

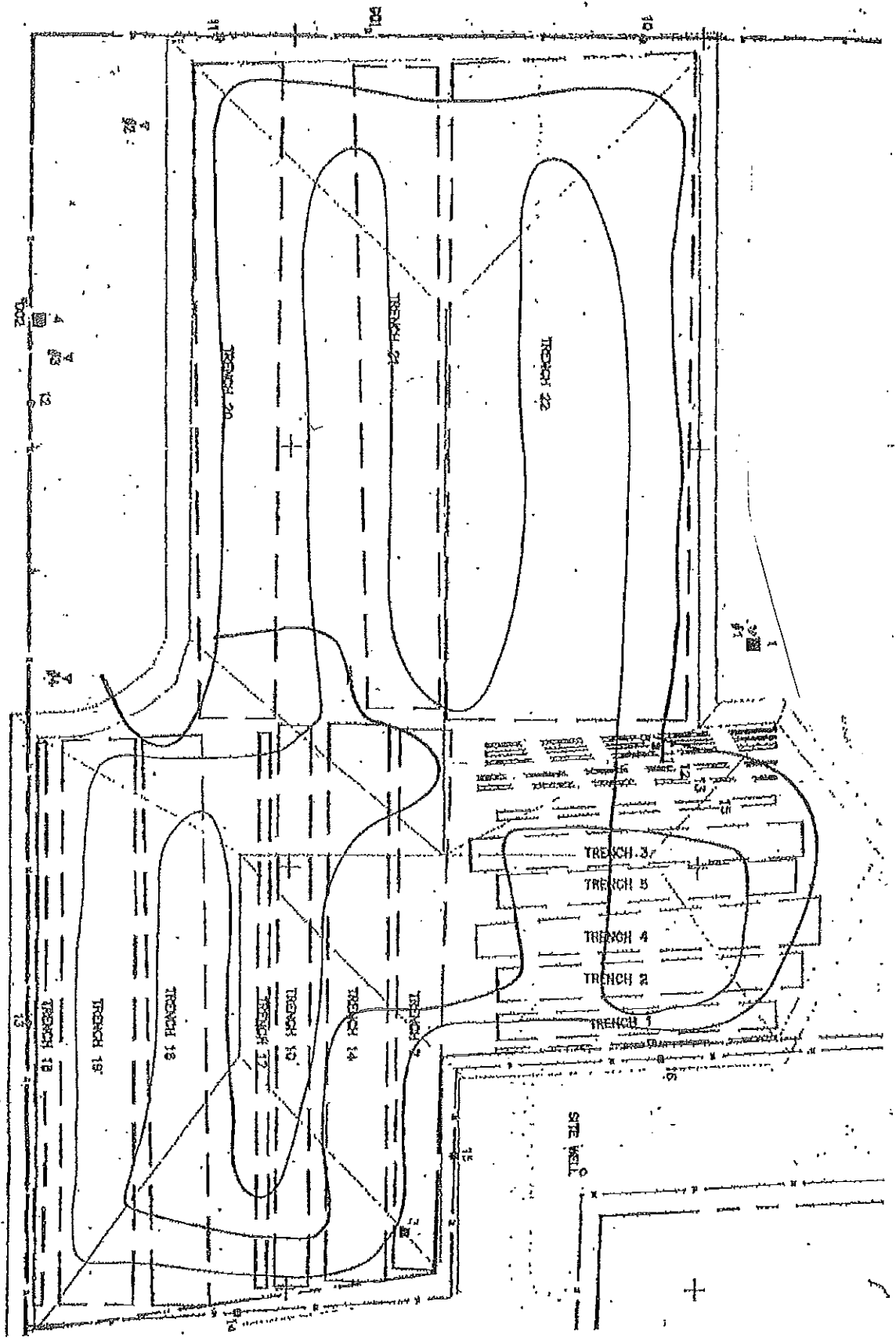



B.

