



The Nevada Health Connection Supported by OpenBeds ®

Elyse Monroy, OD2A Program Manager
Miranda Branson, OD2A OpenBeds Coordinator

Nevada Overdose Data to Action

- ▶ Nevada's Primary Source of CDC for Overdose Surveillance, and CDC prevention and intervention work.
- ▶ 4 year Grant through DPBH - OPHIE
 - ▶ UNR-CHS; PHTC, Project Management and Implementation
- ▶ Surveillance
 - ▶ Nonfatal and Fatal
 - ▶ Hospital, EMS, ODMAPS
- ▶ Prevention
 - ▶ PDMP (E.H.R Integration, NarxCare)
 - ▶ Support Community Spike Reponses Planning through the development of comprehensive spike alerts.
 - ▶ **Linkage to Care (OpenBeds)**

What is OpenBeds?

- Electronic Behavioral Health and Social Services Referral tool
- OpenBeds is the software that facilitates the development of the Nevada Health Connection
- Nevada is implementing OpenBeds through the CDC Overdose Data to Action Program
- OpenBeds will support the State's in implementing the Crisis Now Model
- OpenBeds supports hospital's and their ability to report data to the state in compliance with AB85

How does it support the development of resource guides?

- OpenBeds is a Behavioral Health Services Registry- Referring providers *or members of the public* can log in to check services
- OpenBeds has a tie to 211. When a referring provider sends a referral for treatment, they can send a simulations referral for 211.

How OpenBeds[®] Works: 4 Steps

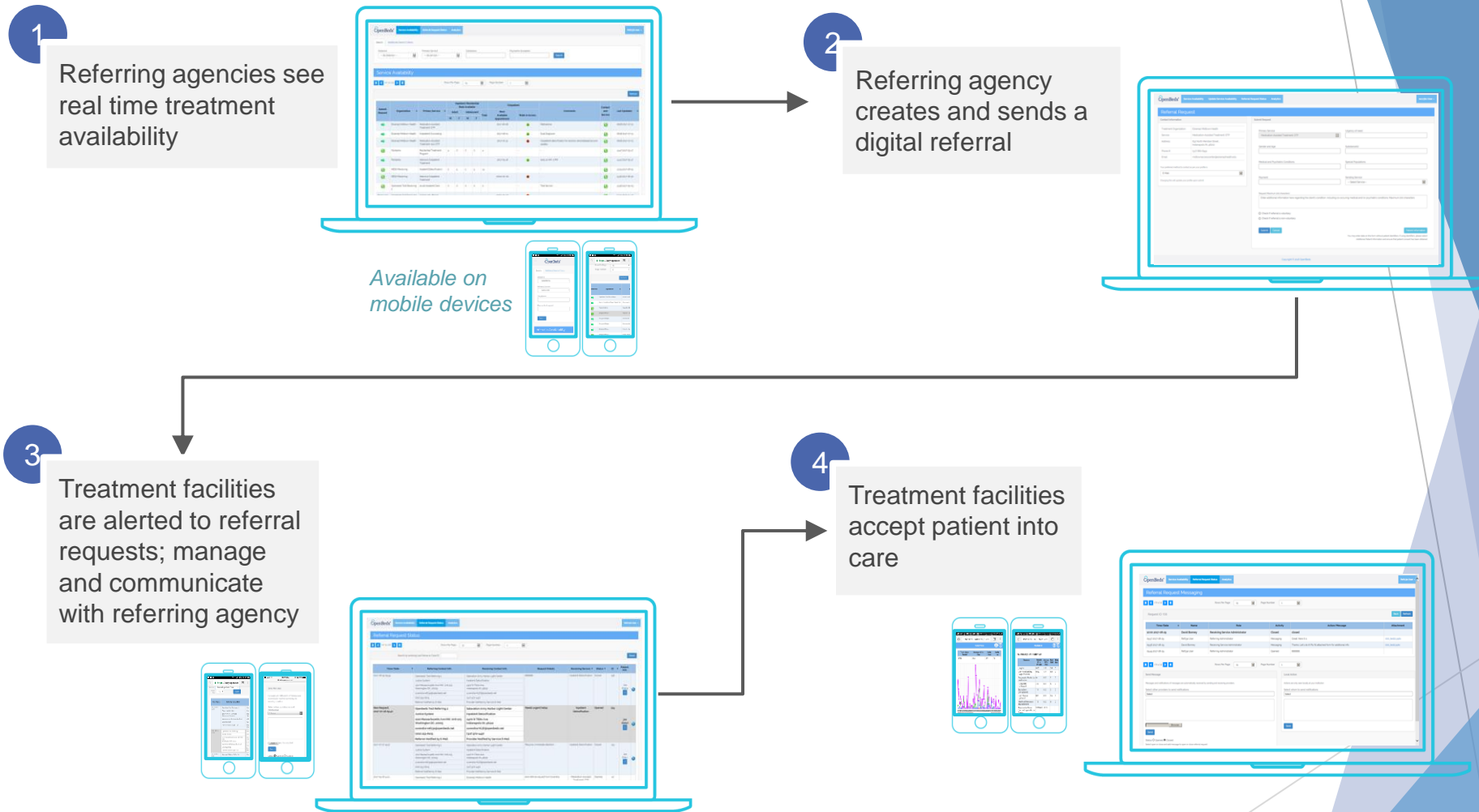

Simple process to filter and find a bed or treatment slot, create/send/process a request -- in less than 2 minutes, provider is back to work

Real-time Service Availability

OpenBeds® **Service Availability** Referral Request Status Analytics Steve1a Carroll -

Search Criteria [Additional Search Criteria](#) [Search by Distance](#)

Primary Service Substance Payments Accepted Search by ZIP Search

Service Availability

Submit Request	Organization ▾	Primary Service ▾	Inpatient/Residential Beds Available				Total	Outpatient		Comments	Contact and Service Info	Last Updated ▾
			Adult		Adolescent			Next Available Appointment	Walk-in Access			
			M	F	M	F						
→	Add to 'Unable to Place Patient' list	Community-Based Services							●	Having trouble referring a client? Submit a form without identifiers. We keep a list to improve care delivery.	i	09:06 02-08-2019
→	Amethyst House	Residential Treatment Program-1	0	-	-	-	0			Men's Residential Treatment. An in-person interview is required prior to admission.	i	15:51 02-05-2019
→	Amethyst House	Residential Treatment Program-2	-	4	-	-	4			Women's Residential Treatment. An in-person interview is required prior to admission.	i	15:51 02-05-2019
→	Aspire Indiana	Outpatient Counseling							●	We have locations in Boone, Hamilton, Madison, and Marion County. Please contact first for walk in times/urgent intakes.	i	08:48 02-11-2019
→	Brentwood Springs	Acute Inpatient / Dual Diagnosis	8	8	-	-	16			Bed availability not gender specific. Walk in available 24/7	i	13:28 02-07-2019
→	Bridges of Hope	Residential Treatment Program	5	6	-	-	11			Dual Diagnosis Treatment	i	14:47 01-22-2019
→	Bridges of Hope	Intensive Outpatient Treatment						01-23-2019	●	Please refer to contact info for Service Hours.	i	14:47 01-22-2019
→	Centerstone Recovery Center	Residential Treatment Program	-	2	-	0	2			The Centerstone Recovery Center is for women only. A phone intake and assessment are required to determine medical necessity prior to admission. Non-Centerstone clients need to call 800-344-8802	i	14:46 01-10-2019



Referral Request

Contact Information

Treatment Organization:	Fairbanks
Service:	Residential Treatment Program
Address:	8102 Clearvista Parkway, Indianapolis IN, 46256
Phone #:	(317) 572-9396
Email:	fairbanksopenbeds@ecommunity.com

Your preferred method to contact as per your profile is

E-Mail

Changing this will update your profile upon submit

Submit Request

Primary Service*

Residential Treatment Program

Urgency of need*

Client is perceived to be at high risk for crisis

Gender and Age*

Youth (17 and under)

Substance(s) – leave blank if not applicable

Alcohol

Medical and Psychiatric Conditions

Schizophrenia and other psychotic disorders

Special Populations*

Youth (17 and under)

Payment*

Medicaid/Expanded Medicaid

Sending Service*

Inpatient Detoxification

Request (Maximum 200 characters)*

Enter additional information here regarding the client's condition including co-occurring medical and/or psychiatric conditions. Maximum 200 characters

- Check if referral is voluntary
- Check if referral is non-voluntary

Submit Cancel

Wrap Around Services

This generates a notification to 211. Consent the patient about 211 contacting them. 211 will reach out within 48 hours.

Patient Information

You may enter data on this form without patient identifiers. If using identifiers, please select Patient Information and ensure that patient consent has been obtained



Nevada Health Connection Metrics

Launched August 13th 2020



1,681 referral since August 13th -
September 30th, 2021.



39 Receiving Providers



29 Referring Providers

Metrics- Network Activity

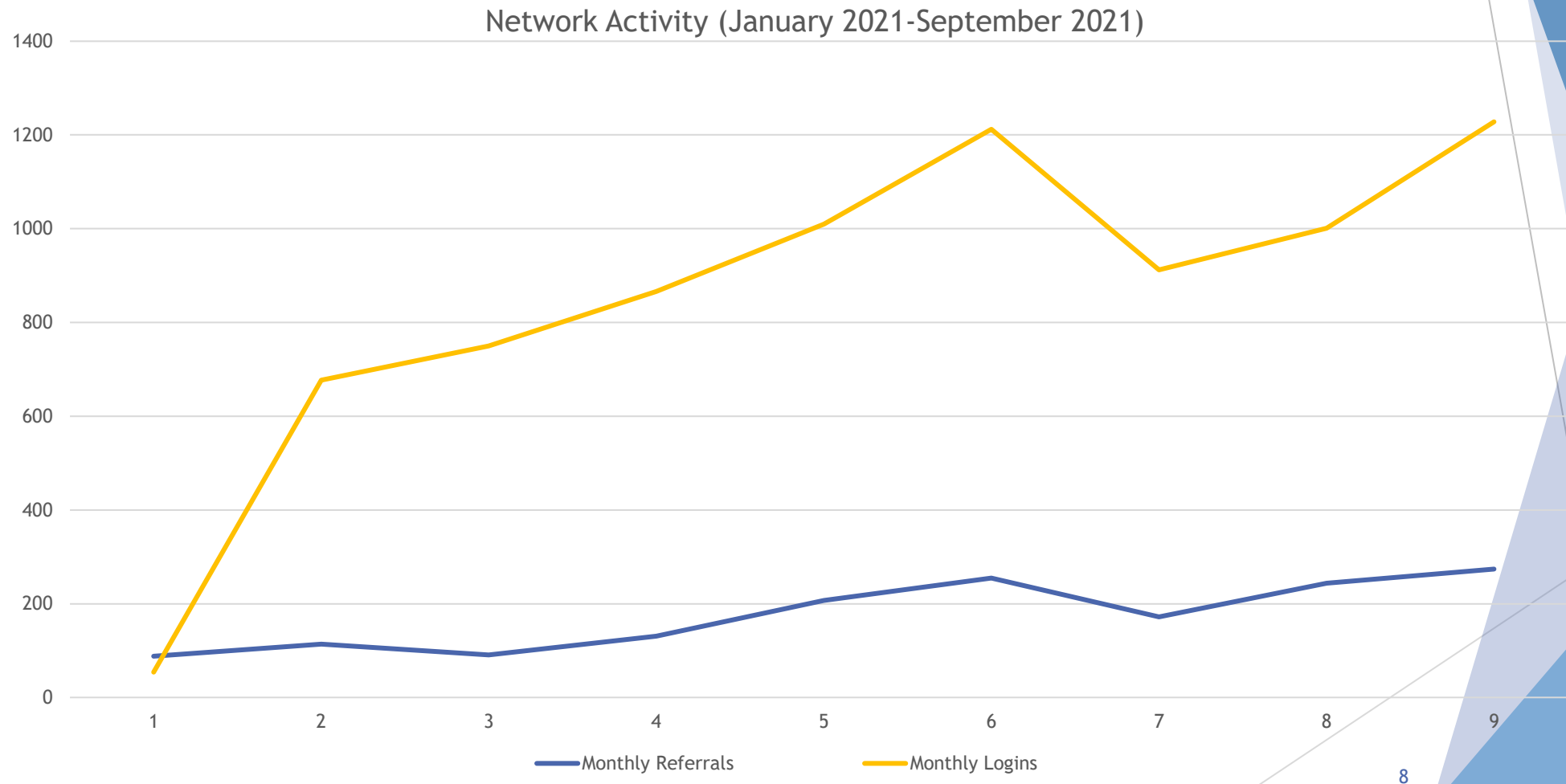

Search for treatment availability in your community from anywhere!

TreatmentConnection.com

Search Substance Use or Mental Health Treatment Facilities

Use filters to narrow down your search results and find treatment facilities.

Clear Filters

Zip Code

89502

Distance From Zip Code

Any distance

Substances

Gender and Age

Treatment Type

- Mental Health Inpatient
- Mental Health Outpatient
- Recovery Housing
- Substance Use Outpatient

Payment Type

89 matches found based on your selection.

These Facilities have been vetted by the State government

List View Map View

Reno Behavioral Healthcare Hospital - Inpatient Psychiatric

More Information

6940 Sierra Center Pkwy.
Reno, NV 89511

(775) 393-2201

View Website

2.76 miles from your zip code

● Taking Patients Currently
Last updated on 02-24-2021

Contact About Treatment

Reno Behavioral Healthcare Hospital - Inpatient Withdrawal Management

More Information

6940 Sierra Center Pkwy.
Reno, NV 89511

(775) 393-2201

View Website

2.76 miles from your zip code

● Taking Patients Currently
Last updated on 02-24-2021

Contact About Treatment

Reno Behavioral Healthcare Hospital - Residential Treatment Program (SUD)

More Information

6940 Sierra Center Pkwy.
Reno, NV 89511

(775) 393-2201

View Website

9
2.76 miles from your zip code



OVERDOSE

Questions?

Thank you!

Contact Information

- ▶ Elyse Monroy | Ecmonroy@unr.edu
- ▶ Miranda Branson | mirandabranson@unr.edu

Funding Disclosure

This presentation is supported by the Nevada State Department of Health and Human Services through Grant Number NU17CE925001 from the Centers for Disease Control and Prevention.

Its contents are solely the responsibility of the authors and do not necessarily represent the official views of the Department nor the Centers for Disease Control and Prevention.